**DESIGN:**

- 2 or 3 teeth, straight cut. Cutters work in pairs to produce single or multiple dowels
- H.S.S. Tipped cutting edges

APPLICATION:

- To produce single or multiple dowels
- On moulders
- All dowels produced must be guided at three points all the way (ILL.2). Guide must take hold of dowels immediately after leaving cutting edge area. (ILL.3)

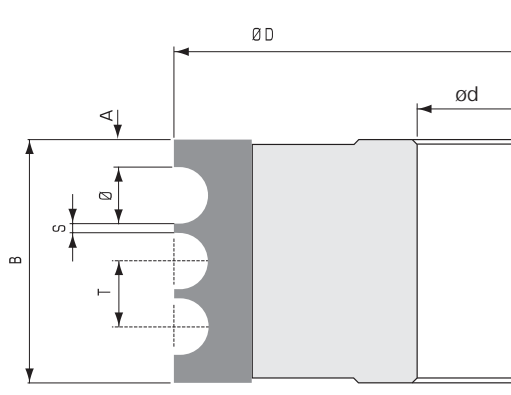

(ILL.2)

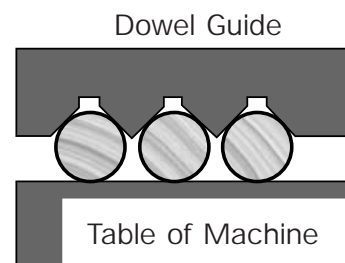

(ILL. 3)

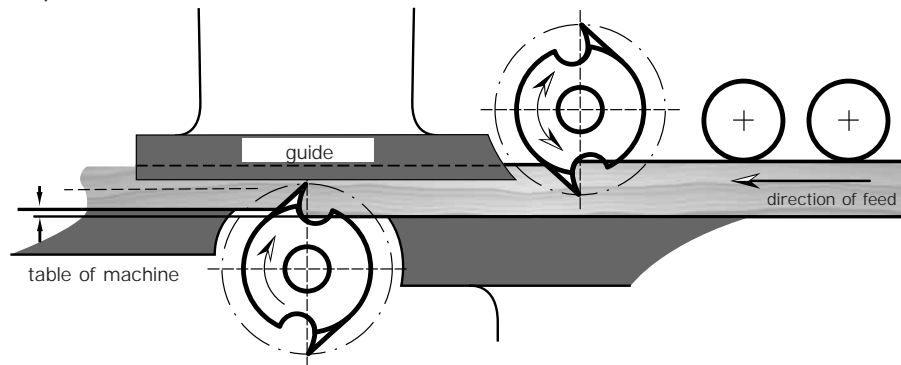

DIMENSIONS															
Diam. of dowel Ø mm	3	4	5	6	7	8	9	10	11	12	13	14	15	16	
Splitting point S mm	1	1	1	1	1	1	1	1	1.5	1.5	1.5	1.5	1.5	1.5	
Pitch T mm	4	5	6	7	8	9	10	11	12.5	13.5	14.5	15.5	16.5	17.5	
Square end A mm	4	4	4	4	4	4	4	5	5	5	5	5	5	5	
Diam. ØD mm	120	120	120	120	120	120	120	120	120	120	120	120	120	140	
Kerf B mm	1	11	12	13	14	15	16	17	20	21	22	23	25	26	
No. of dowels	2	15	17	19	21	23	25	27	31	33.5	35.5	37.5	39.5	41.5	43.5
	3	19	22	25	28	31	34	37	42	46	49	52	55	58	61
	4	23	27	31	35	39	43	47	53	58.5	62.5	66.5	70.5	74.5	78.5
	5	27	32	37	42	47	52	57	64	71	76	81	86	91	96
	6	31	37	43	49	55	61	67	75	83.5	89.5	95.5	101.5	107.5	113.5
	7	35	42	49	56	63	70	77	86	96	103	110	117	124	131
	8	39	47	55	63	71	79	87	97	108.5	116.5	124.5	132.5	140.5	148.5
	9	43	52	61	70	79	88	97	108	121	130	139	148		
	10	47	57	67	77	87	97	107	119	133.5	143.5				
	11	51	62	73	84	95	106	117	130	146					
Diam. of dowel Ø mm	17	18	19	20	21	22	23	24	25	26	27	28	29	30	
Splitting point S mm	1.5	1.5	1.5	2	2	2	2	2	2	2	2	2	2	2	
Pitch T mm	18.5	19.5	20.5	22	23	24	25	26	27	28	29	30	31	32	
Square end A mm	5	5	5	5	7	7	7	7	7	7	7	7	7	7	
Diam. ØD mm	140	140	140	140	140	140	140	140	160	160	160	160	160	160	
Kerf B mm	1	27	28	29	30	35	36	37	38	39	40	41	42	43	44
No. of dowels	2	45.5	47.5	49.5	52	58	60	62	64	66	68	70	72	74	76
	3	64	67	70	74	81	84	87	90	93	96	99	102	105	108
	4	82.5	86.5	90.5	96	104	108	112	116	120	124	128	132	136	140
	5	101	106	111	118	127	132	137	142	147					
	6	119.5	125.5	131.5	140										

The minimum diameter indicated allows for centre bore of 40mm max.
Other sizes available upon request.