**DESIGN:**

- Hogger body made of light alloy equipped with 4 or 6 segments and 1 saw blade, all TC tipped, replaceable and resharpenable
- Standard chipping width 30mm, wider chipping widths in multiples of 30mm can be achieved by adding multiple elements which must be specified when ordering

APPLICATION:

- For chip-free sizing of panel materials on double-end tenoners and trimming machines

| PART NO. | ROTATION | DIAM. mm | KERF mm | BORE mm | NO. TEETH SAWS | NO. TEETH SEGMENTS |
|----------|----------|-------------|------------|------------|-------------------|-----------------------|
| 1TL504 | LH | 255 | 30 | 60 | 40 | 4x8 |
| 1TL514 | RH | 255 | 30 | 60 | 40 | 4x8 |
| 1TL506 | LH | 255 | 30 | 60 | 60 | 4x8 |
| 1TL516 | RH | 255 | 30 | 60 | 60 | 4x8 |
| 1TL524 | LH | 255 | 30 | 80 | 40 | 4x8 |
| 1TL534 | RH | 255 | 30 | 80 | 40 | 4x8 |
| 1TL526 | LH | 255 | 30 | 80 | 60 | 4x8 |
| 1TL536 | RH | 255 | 30 | 80 | 60 | 4x8 |
| 1TL804 | LH | 300 | 30 | 60 | 48 | 6x7 |
| 1TL814 | RH | 300 | 30 | 60 | 48 | 6x7 |
| 1TL806 | LH | 300 | 30 | 60 | 72 | 6x7 |
| 1TL816 | RH | 300 | 30 | 60 | 72 | 6x7 |
| 1TL824 | LH | 300 | 30 | 80 | 48 | 6x7 |
| 1TL834 | RH | 300 | 30 | 80 | 48 | 6x7 |
| 1TL826 | LH | 300 | 30 | 80 | 72 | 6x7 |
| 1TL836 | RH | 300 | 30 | 80 | 72 | 6x7 |
| 1TL906 | LH | 350 | 30 | 60 | 84 | 6x8 |
| 1TL916 | RH | 350 | 30 | 60 | 84 | 6x8 |
| 1TL926 | LH | 350 | 30 | 80 | 84 | 6x8 |
| 1TL936 | RH | 350 | 30 | 80 | 84 | 6x8 |

SPARE SAWS (one side bevel)

| PART NO. LEFT | PART NO. RIGHT | DIAM. mm | KERF mm | BORE mm | NO.OF TEETH | TOOTH SHAPE |
|------------------|-------------------|-------------|------------|------------|----------------|----------------|
| 525240 | 525340 | 255 | 4.2 | 155 | 40 | BEV. |
| 525260 | 525360 | 255 | 4.2 | 155 | 60 | BEV. |
| 530248 | 530348 | 300 | 4.2 | 155 | 48 | BEV. |
| 530272 | 530372 | 300 | 4.2 | 155 | 72 | BEV. |
| 535084 | 535384 | 350 | 4.2 | 200 | 84 | BEV. |

- W500605 Spare screw for saws
- W500701 Spare screw for segments

SPARE SEGMENTS

| PART NO. | DIAM.mm | TEETH |
|----------|---------|-------|
| 525008 | 245 | 8 |
| 530008 | 295 | 7 |
| 535008 | 345 | 8 |

1TL2 HOGGING UNITS WITH DISPOSABLE KNIVES

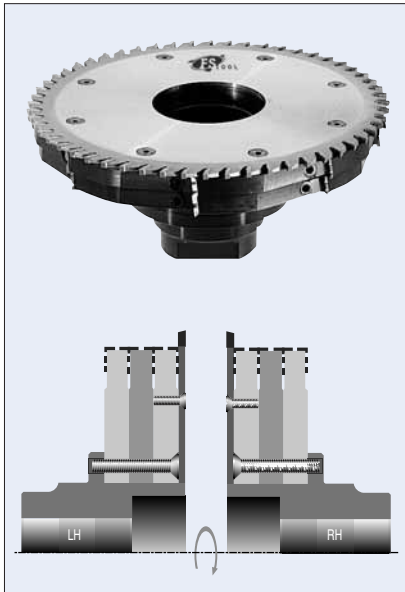

DESIGN:

- High tensile strength steel body with solid carbide reversible inserts
- Inserts have 4 cutting edges with chip breaker
- Hogger set consists of elements which can be of three different diameters (234, 242 and 250mm). This allows for different profile solutions as per drawing examples
- Chipping width available from 19.2mm and wider, in increments of 15mm

APPLICATION:

- For chip-free sizing of panel materials on double-end tenoners and trimming machines

HOGGING UNIT BODY

| PART NO. | DIAM. mm | KERF mm | BORE mm | NO.OF TEETH | HOGGER NO. | ROTATION |
|----------|----------|---------|---------|-------------|------------|----------------|
| 1TL250LH | 250 | 15 | 80 | 8 | 1 | LEFT HAND (1) |
| 1TL250RH | 250 | 15 | 80 | 8 | 1 | RIGHT HAND (1) |
| 1TL242LH | 242 | 15 | 80 | 8 | 2 | LEFT HAND (2) |
| 1TL242RH | 242 | 15 | 80 | 8 | 2 | RIGHT HAND (2) |
| 1TL234LH | 234 | 15 | 80 | 8 | 3 | LEFT HAND (3) |
| 1TL234RH | 234 | 15 | 80 | 8 | 3 | RIGHT HAND (3) |

SAW BLADE

| PART NO. | DIAM. mm | KERF mm | BORE mm | NO.OF TEETH | ROTATION |
|----------|----------|---------|---------|-------------|------------|
| 1TL255LH | 255 | 4.2 | 80 | 56 | LEFT HAND |
| 1TL255RH | 255 | 4.2 | 80 | 56 | RIGHT HAND |

SLEEVE-STANDARD PRODUCTION

| PART NO. | DIAM. mm | LENGTH mm | BORE mm | KEYWAY (one) mm |
|-----------|----------|-----------|---------|-----------------|
| 1TL115-35 | 115 | 92 | 35 | 10 x 4 |
| 1TL115-40 | 115 | 92 | 40 | 12 x 5 |

SPACER

| PART NO. | DIAM. mm | THICKNESS mm | BORE mm |
|----------|----------|--------------|---------|
| 1TL116 | 115 | 14 | 80 |

REPLACEMENT PARTS

| PART NO. | DESCRIPTION |
|----------|--|
| 301505 | Insert with chip breaker 15 x 15 x 2 mm |
| W500601 | Bolt for mounting hogger body M8 x 50 mm |
| W500605 | Bolt for mounting saw blade M6 x 16 mm |
| W350064 | Gib for left hand hogger body |
| W350065 | Gib for right hand hogger body |
| W502402 | Bolt for gibs M7 x 21 mm |



301505

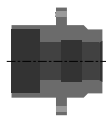

1TL115-35
1TL115-40



1TL116



W350064
W350065



W502402



W500601
W500605