

R2500 HALF ROUND BITS (BULL NOSE)

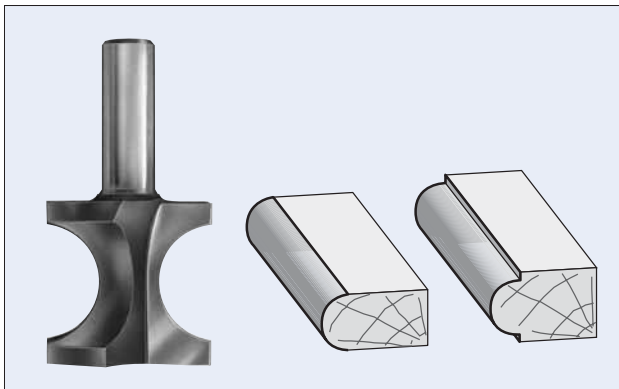

PART NO.	LARGE DIAM.	RADIUS	CUTTER OPENING	CARBIDE HEIGHT	SHANK DIAM.
R2500-1	17/32"	5/64"	5/32"	1/2"	1/4"
R2500-2	17/32"	5/64"	5/32"	1/2"	1/2"
R2500	19/32"	7/64"	7/32"	1/2"	1/4"
R2501	21/32"	9/64"	9/32"	3/4"	1/4"
R2502	7/8"	13/64"	13/32"	3/4"	1/4"
R2503	1-1/32"	17/64"	35/64"	1"	1/4"
R2504	19/32"	7/64"	7/32"	1/2"	1/2"
R2505	21/32"	9/64"	9/32"	3/4"	1/2"
R2506	7/8"	13/64"	13/32"	3/4"	1/2"
R2507	1-1/32"	17/64"	35/64"	1"	1/2"
R2507-1	1-1/16"	5/16"	5/8"	1-1/8"	1/2"
R2508	1-5/16"	3/8"	3/4"	1-3/8"	1/2"
R2509	1-11/16"	1/2"	1"	1-9/16"	1/2"
R2510	2"	5/8"	1-1/4"	2"	1/2"
R2511	2-3/8"	3/4"	1-1/2"	2"	1/2"
R2511-1*	2-3/8"	3/4"	1-1/2"	2"	1/2"

* Max. RPM 16,000

* This router bit has 3 flutes and is suitable for cutting solid surface materials, solid woods and composite materials

R2512 HALF ROUND BITS (BULL NOSE) WITH BEARING

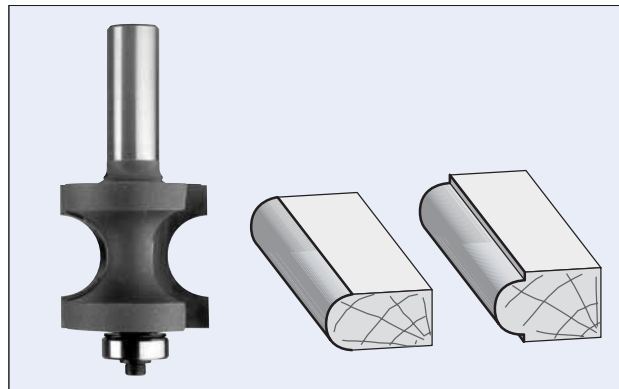

PART NO.	LARGE DIAM.	RADIUS	CUTTER OPENING	CARBIDE HEIGHT	SHANK DIAM.
R2512(A)	25/32"	9/64"	17/64"	3/4"	1/2"
R2513(A)	29/32"	13/64"	25/64"	3/4"	1/2"
R2514(A)	1-1/32"	17/64"	35/64"	1"	1/2"
R2515(B)	1-3/8"	3/8"	3/4"	1-1/4"	1/2"
R2516(C)	1-3/4"	1/2"	1"	1-9/16"	1/2"
R2517(D)	2"	5/8"	1-1/4"	2"	1/2"

Replacement Parts

- | | |
|-----------------------|---------------|
| (A) Ball Bearing B3 | Washer WR58 |
| Spring washer WFS506 | Screw WNC538 |
| (B) Ball Bearing B3-4 | Washer WR59 |
| Spring Washer WFS506 | Screw WNC512 |
| (C) Ball Bearing B4 | Washer WR59 |
| Spring Washer WFS508 | Screw WNF1012 |
| (D) Ball Bearing B4 | Washer WR59 |
| Spring Washer WFS508 | Screw WNF1012 |

R2519 BULL NOSE BIT WITH UPPER BALL BEARING - PLUNGE TYPE

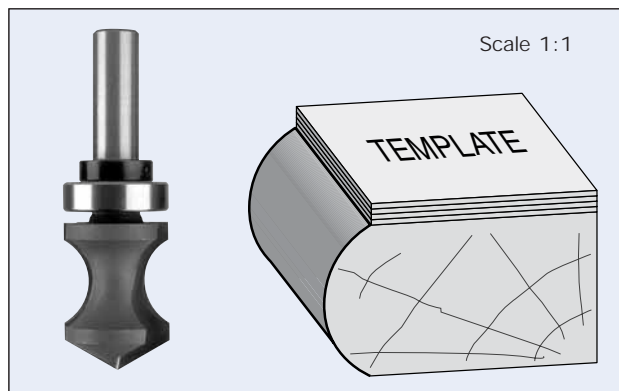

PART NO.	LARGE DIAM.	RADIUS	CUTTER OPENING	CUTTING LENGTH	SHANK DIAM.
R2519	1-1/8"	1/2"	7/8"	1-9/16"	1/2"

Overall length of bit 3-5/8"

Replacement Parts

- | | | |
|-------------------|---------------|--------------|
| Ball Bearing B6-4 | Lock Ring W03 | Screw WNC518 |
|-------------------|---------------|--------------|

R2520 TRUE BULL NOSE BIT
TWO FLUTES

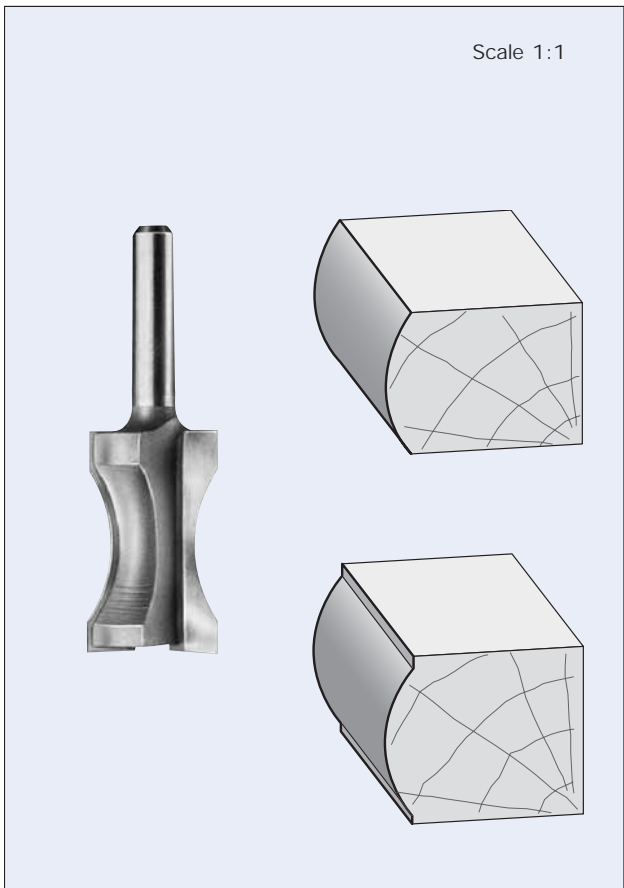

PART NO.	CUTTING DIAM.	RADIUS	CUTTING LENGTH.	SHANK DIAM.	OVERALL LENGTH
R2520	13/16"	23/32"	1-1/4"	1/4"	2-1/2"
R2521	13/16"	23/32"	1-1/4"	1/2"	2-3/4"

R2525 ADJUSTABLE
ROUNDING OVER SET 3 WINGS

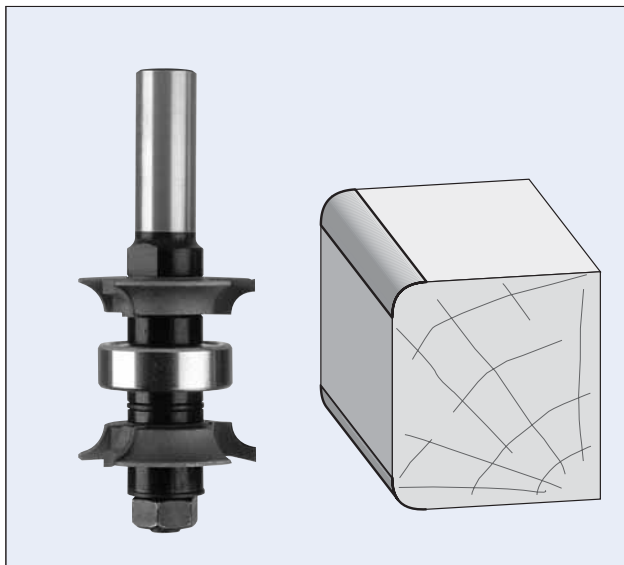

PART NO.	LARGE DIAM.	RADIUS	SHANK DIAM.	OVERALL LENGTH
R2525	1-1/2"	3/16"	1/2"	3-5/8"
R2526	1-5/8"	1/4"	1/2"	3-5/8"
R2527	1-7/8"	3/8"	1/2"	3-5/8"

Fully adjustable set for corner rounding top and bottom in just one pass.

R 3/16" Adjustable from 3/8" to 1-1/4" wood thickness
 R 1/4" Adjustable from 1/2" to 1-1/4" wood thickness
 R 3/8" Adjustable from 3/4" to 1-1/4" wood thickness

Replacement Cutters

R 3/16"	Top cutter	(right)	R2525CR
R 3/16"	Bottom cutter	(left)	R2525CL
R 1/4"	Top cutter	(right)	R2526CR
R 1/4"	Bottom cutter	(left)	R2526CL
R 3/8"	Top cutter	(right)	R2527CR
R 3/8"	Bottom cutter	(left)	R2527CL

Replacement Parts

- Ball Bearing B6-3
- Arbor and nut AR20
- Nut only WNF516
- Spacer A (6.0mm 2 pcs.) WF618
- Spacer B (3.0mm 1 pc.) WF610
- Spacer C (1.0mm 2 pcs.) WF608
- Spacer D (0.5mm 2 pcs.) WF606
- Spacer E (0.1mm 6 pcs.) WF604